



U3917 (UI 39/17)

24VA - Ta40°C

20VA - Ta70°C



www.eifter.com

weight - 490gr.

ENCAPSULATED TRANSFORMERS

[home>>index](#)

According EN61558, EN60590, EN60472, UL506, UL1585, UL5085 · External protection

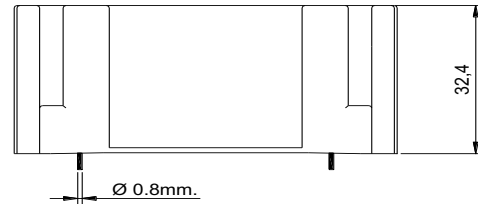
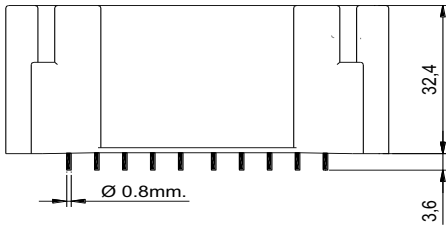

24VA. Ta40°C

HR REFERENCE		Vo/Vsec=1,3 Vo → Is=0 Vsec → Isec=In		Prot. Prim. 230V: 125mA/T 115V: 250mA/T
U39140xx	U39145xx	Vsec	Isec	Prot. Sec. mA/F
U3917007	U3917507	2x4,5V	2x2666mA	2x3150mA
U3917000	U3917500	2x6V	2x2000mA	2x2500mA
U3917001	U3917501	2x7,5V	2x1600mA	2x2000mA
U3917002	U3917502	2x9V	2x1333mA	2x1600mA
U3917003	U3917503	2x12V	2x1000mA	2x1250mA
U3917004	U3917504	2x15V	2x800mA	2x1000mA
U3917005	U3917505	2x18V	2x666mA	2x800mA
U3917006	U3917506	2x24V	2x500mA	2x630mA

U39xx0xx

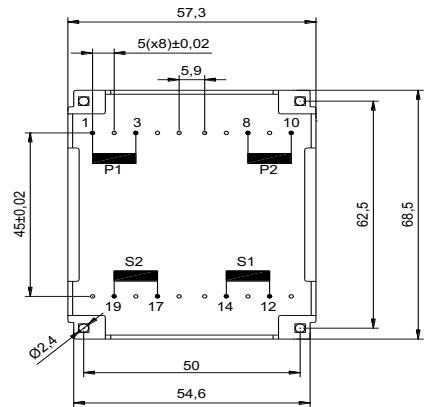

20VA. Ta70°C

HR REFERENCE		Vo/Vsec=1,3 Vo → Is=0 Vsec → Isec=In		Prot. Prim. 230V: 125mA/T 115V: 250mA/T
U39140xx	U39145xx	Vsec	Isec	Prot. Sec. mA/F
U3917057	U3917557	2x4,5V	2x2222mA	2x2500mA
U3917050	U3917550	2x6V	2x1666mA	2x2000mA
U3917051	U3917551	2x7,5V	2x1333mA	2x1600mA
U3917052	U3917552	2x9V	2x1111mA	2x1250mA
U3917053	U3917553	2x12V	2x833mA	2x1000mA
U3917054	U3917554	2x15V	2x666mA	2x800mA
U3917055	U3917555	2x18V	2x555mA	2x630mA
U3917056	U3917556	2x24V	2x416mA	2x500mA

U39xx5xx

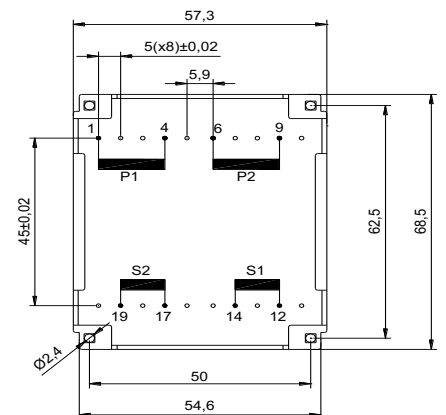

Primary connections

Secondary connections

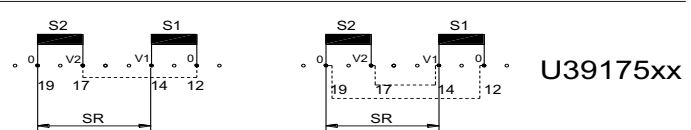
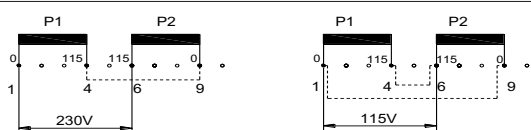
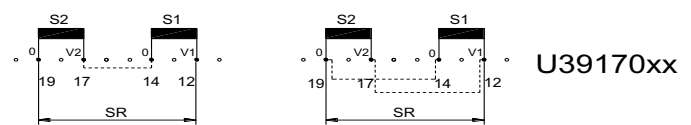
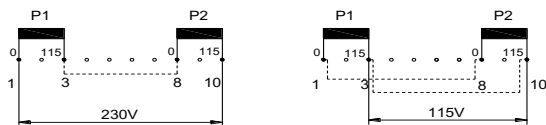

Vsr=V1+V2
Isr=I1

Vsr=V1
Isr=I1+I2

According EN61558, EN60590, EN60472, UL506, UL1585, UL5085.