



# U4826 (UI 48/26)

55VA - Ta40°B

60VA - Ta70°B



www.efiter.com

weight - 1,1kgr.

## ENCAPSULATED TRANSFORMERS

[home>>index](#)

According EN61558, EN60590, EN60472, UL506, UL1585, UL5085 · External protection

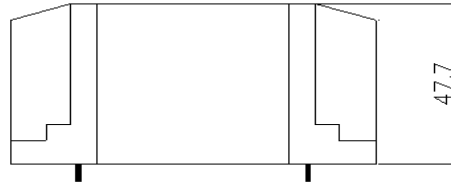
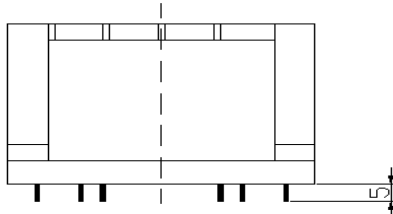

### 55VA. Ta°40B

### U48xx0xx

HR REFERENCE		Vo/Vsec=1,2 Vo --> Is=0 Vsec --> Isec=In		Prot. Prim. 230V: 160mA/T 115V: 315mA/T
U48260xx	U48265xx	Vsec	Isec	Prot. Sec. mA/F
U4826007	U4826507	2x4,5V	2x6111mA	2x6150mA
U4826000	U4826500	2x6V	2x4583mA	2x4750mA
U4826001	U4826501	2x7,5V	2x3666mA	2x3750mA
U4826002	U4826502	2x9V	2x3055mA	2x3100mA
U4826003	U4826503	2x12V	2x2291mA	2x2300mA
U4826004	U4826504	2x15V	2x1833mA	2x1875mA
U4826005	U4826505	2x18V	2x1527mA	2x1550mA
U4826006	U4826506	2x24V	2x1145mA	2x1150mA

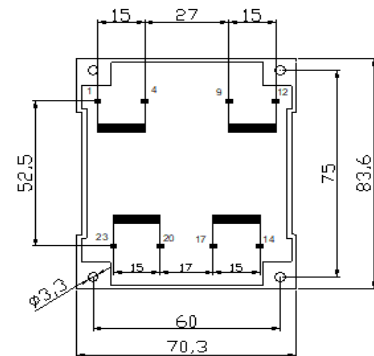

### 60VA. Ta°70B

### U48xx5xx

HR REFERENCE		Vo/Vsec=1,2 Vo --> Is=0 Vsec --> Isec=In		Prot. Prim. 230V: 160mA/T 115V: 315mA/T
U48260xx	U48265xx	Vsec	Isec	Prot. Sec. mA/F
U4826057	U4826557	2x4,5V	2x6666mA	2x66750mA
U4826050	U4826550	2x6V	2x5000mA	2x5150mA
U4826051	U4826551	2x7,5V	2x4000mA	2x4050mA
U4826052	U4826552	2x9V	2x3333mA	2x1600mA
U4826053	U4826553	2x12V	2x2500mA	2x2550mA
U4826054	U4826554	2x15V	2x2000mA	2x2050mA
U4826055	U4826555	2x18V	2x1666mA	2x1675mA
U4826056	U4826556	2x24V	2x1250mA	2x1275mA

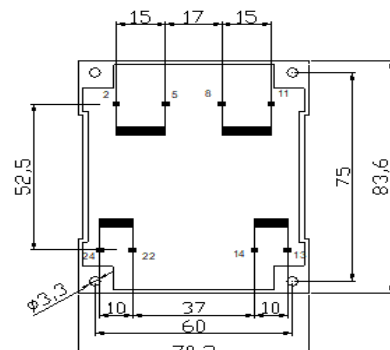

#### Primary connections

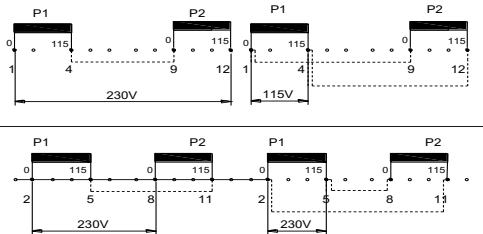

#### Secondary connections

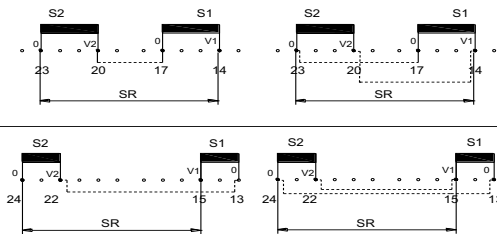

U48260xx

U48265xx

$$V_{sr} = V1 + V2$$

$$I_{sr} = I1$$

$$V_{sr} = V1$$

$$I_{sr} = I1 + I2$$

According EN61558, EN60590, EN60472, UL506, UL1585, UL5085 .