



SWITCH MODE POWER SUPPLY SMPS20

3W



www.efiter.com

home>>products

According EN61558, EN60590, EN60472, UL506, UL1585, UL5085 · External protection

FEATURES

Input AC voltage range	85-265Vac	Output short circuit prot.	Yes
Line Frequency	47-63Hz	Thermal protection	Yes
Input current (full load)	0.15A max at 85Vac-265Vac	Hi pot	4000 Vac (5mA, 3 seconds)
Input Power (no load)	≤ 0.15W at 230V	DC-Insulation resistance	10MΩ min. at 500Vdc
Output ripple	≤ 200mV	Output line regulation	±2%
Rise time output voltage	200ms at 80%	Output load regulation	±5%
Output overcurrent prot.	Yes		

ELECTRICAL CHARACTERISTICS

REFERENCE	OUTPUT VOLTAGE (V)	OUTPUT CURRENT (A)	OUTPUT POWER (W)	OPERATING AMBIENT (°C)	OUTPUT REGULATION	EFFICIENCY
SMPS-2003103	3,3	0,3	1	80	±5%	≥65%
		0,75	2,5	60		
		0,9	3	50		
SMPS-2003105	5	0,2	1	80	±5%	≥65%
		0,5	2,5	60		≥75%
		0,9	3	50		≥75%
SMPS-2003109	9	0,11	1	80	±5%	≥65%
		0,17	2,5	70		≥75%
		0,33	3	60		≥75%
SMPS-2003112	12	0,08	1	80	±5%	≥65%
		0,2	2,5	70		≥75%
		0,25	3	60		≥75%
SMPS-2003115	15	0,06	1	80	±5%	≥65%
		0,16	2,5	70		≥75%
		0,2	3	60		≥75%
SMPS-2003118	18	0,5	1	80	±5%	≥65%
		0,13	2,5	70		≥75%
		0,16	3	60		≥75%
SMPS-2003124	24	0,04	1	80	±5%	≥75%
		0,1	2,5	70		≥75%
		0,12	3	60		≥75%

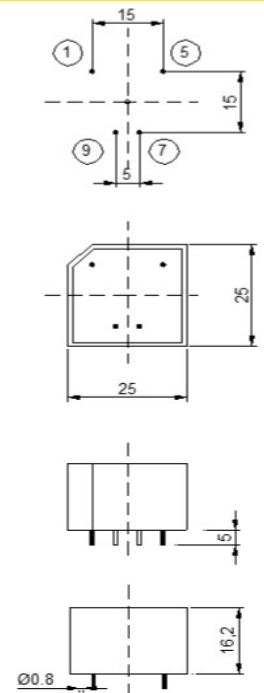

TECHNICAL INFORMATION

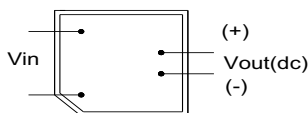

THERMAL CHARACTERISTICS	
Storage ambient temperature	-30°C ~ 85°C
Storage ambient humidity	10% ~ 95%
Operating ambient temperature	-20°C ~ 80°C
Operanting ambient humidity	10% ~ 95%
Maximum working temperature	50°C~ 80°C (see table)
SAFETY	
EMC	According to EN60950,EN60335,EN61558-2-16,EN61558-2-17
Immunity	(Conducted and Radiated Emissions) According to EN55032,EN55014
RoHS	According to EN61000-3-3, EN61000-4-2, EN61000-4-3, EN61000-4-4, EN61000-4-5, EN61000-4-6,EN61000-4-8,EN61000-4-11
	Directive 2015/863/EU