

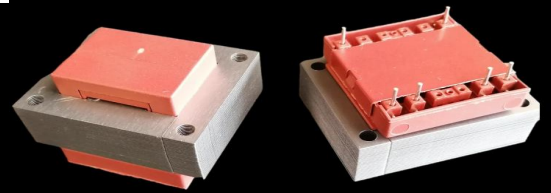

S8450 (EI 84)

150VA - Ta40°C

Dim:70x84x81mm



OPEN FRAME TRANSFORMERS

www.efiter.com

[home>>index](#)

According EN61558, EN60590, EN60472, UL506, UL1585, UL5085 · External protection

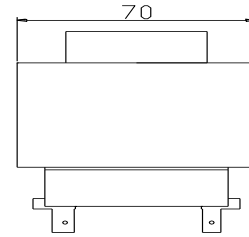
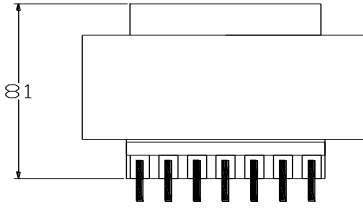
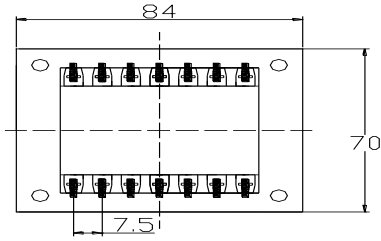

SINGLE SECONDARY, 150VA. Ta40°C

HR REFERENCE		Vo/Vsec=1,3 Vo → Is=0 Vsec → Isec=In		Prot. Prim. 230V: 50mA/T 115V: 100mA/T
Prim. 230V	Prim. 115V	Vsec	Isec	Prot. Sec. mA/F
S8450014	S8450114	4,5V	33333mA	35000mA
S8450000	S8450100	6V	25000mA	30000mA
S8450002	S8450102	7,5V	20000mA	21000mA
S8450004	S8450104	9V	16667mA	17000mA
S8450006	S8450106	12V	12500mA	15000mA
S8450008	S8450108	15V	10000mA	11000mA
S8450010	S8450110	18V	8333mA	10000mA
S8450020	S8450120	20V	7500mA	9000mA
S8450012	S8450112	24V	6250mA	7000mA

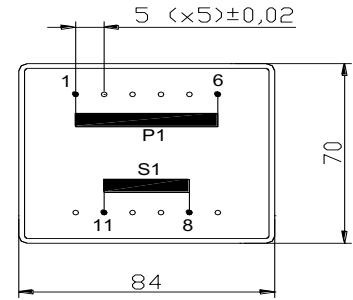

DUAL SECONDARY, 150VA. Ta40°C

HR REFERENCE		Vo/Vsec=1,3 Vo → Is=0 Vsec → Isec=In		Prot. Prim. 230V: 50mA/T 115V: 100mA/T
Prim. 230V	Prim. 115V	Vsec	Isec	Prot. Sec. mA/F
S8450015	S8450115	2x4,5V	2x16667mA	2x17000mA
S8450001	S8450101	2x6V	2x1250mA	2x1500mA
S8450003	S8450103	2x7,5V	2x10000mA	2x1100mA
S8450005	S8450105	2x9V	2x8333mA	2x1000mA
S8450007	S8450107	2x12V	2x6250mA	2x7000mA
S8450009	S8450109	2x15V	2x5000mA	2x6000mA
S8450011	S8450111	2x18V	2x4167mA	2x5000mA
S8450019	S8450119	2x20V	2x3750mA	2x4000mA
S8450013	S8450113	2x24V	2x3125mA	2x4000mA

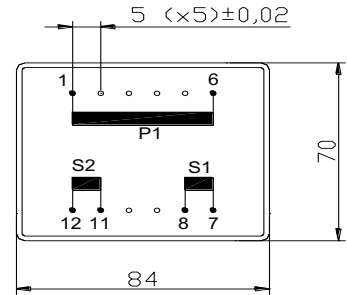

CENTER TAPPED, 150VA. Ta40°C

HR REFERENCE		Vo/Vsec=1,3 Vo → Is=0 Vsec → Isec=In		Prot. Prim. 230V: 50mA/T 115V: 100mA/T
Prim. 230V	Prim. 115V	Vsec	Isec	Prot. Sec. mA/F
S8450035	S8450135	2x4,5V	2x16667mA	2x17000mA
S8450021	S8450121	2x6V	2x1250mA	2x1500mA
S8450023	S8450123	2x7,5V	2x10000mA	2x1100mA
S8450025	S8450125	2x9V	2x8333mA	2x1000mA
S8450027	S8450127	2x12V	2x6250mA	2x7000mA
S8450029	S8450129	2x15V	2x5000mA	2x6000mA
S8450031	S8450131	2x18V	2x4167mA	2x5000mA
S8450039	S8450139	2x20V	2x3750mA	2x4000mA
S8450039	S8450133	2x24V	2x3125mA	2x4000mA

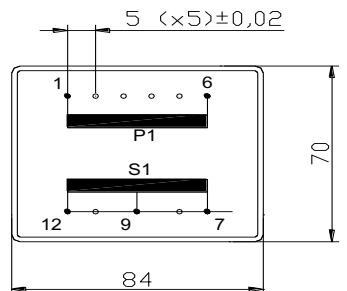

According EN61558, EN60590, EN60472, UL506, UL1585, UL5085