

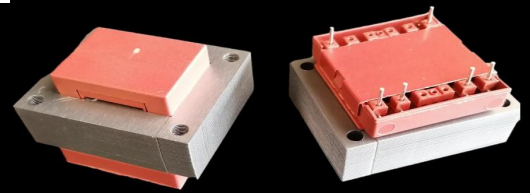

S6021 (EI 60)

20,0VA - Ta70°C

Dim:50x60x42,1mm



OPEN FRAME TRANSFORMERS

www.efiter.com

[home>>index](#)

According EN61558, EN60590, EN60472, UL506, UL1585, UL5085 · External protection

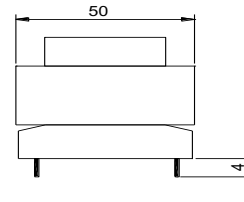
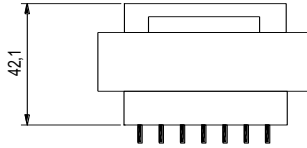
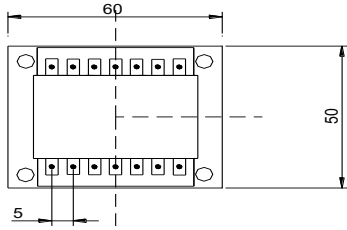

SINGLE SECONDARY, 20VA. Ta70°C

HR REFERENCE		Vo/Vsec=1,3 Vo → Is=0 Vsec → Isec=In		Prot. Prim. 230V: 50mA/T 115V: 100mA/T
Prim. 230V	Prim. 115V	Vsec	Isec	Prot. Sec. mA/F
S6021064	S6021164	4,5V	4444mA	4500mA
S6021050	S6021150	6V	3333mA	3400mA
S6021052	S6021152	7,5V	2667mA	2700mA
S6021054	S6021154	9V	2222mA	2300mA
S6021056	S6021156	12V	1667mA	1700mA
S6021058	S6021158	15V	1333mA	1400mA
S6021060	S6021160	18V	1111mA	1200mA
S6021070	S6021170	20V	1000mA	1100mA
S6021062	S6021172	24V	833mA	900mA

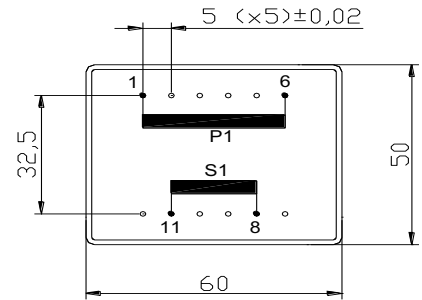

DUAL SECONDARY, 20VA. Ta70°C

HR REFERENCE		Vo/Vsec=1,3 Vo → Is=0 Vsec → Isec=In		Prot. Prim. 230V: 50mA/T 115V: 100mA/T
Prim. 230V	Prim. 115V	Vsec	Isec	Prot. Sec. mA/F
S6021065	S6021165	2x4,5V	2x2222mA	2x2300mA
S6021051	S6021151	2x6V	2x1667mA	2x1700mA
S6021053	S6021153	2x7,5V	2x1333mA	2x1400mA
S6021055	S6021155	2x9V	2x1111mA	2x1200mA
S6021057	S6021157	2x12V	2x833mA	2x900mA
S6021059	S6021159	2x15V	2x667mA	2x700mA
S6021061	S6021161	2x18V	2x556mA	2x600mA
S6021069	S6021169	2x20V	2x500mA	2x550mA
S6021063	S6021163	2x24V	2x417mA	2x500mA

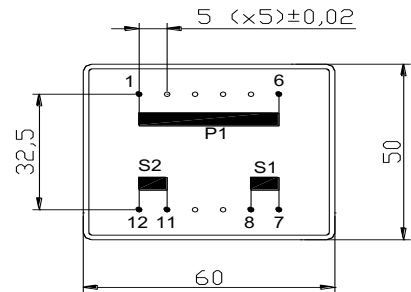

CENTER TAPPED, 20VA. Ta70°C

HR REFERENCE		Vo/Vsec=1,3 Vo → Is=0 Vsec → Isec=In		Prot. Prim. 230V: 50mA/T 115V: 100mA/T
Prim. 230V	Prim. 115V	Vsec	Isec	Prot. Sec. mA/F
S6025085	S6021185	2x4,5V	2x2222mA	2x2300mA
S6021071	S6021171	2x6V	2x1667mA	2x1700mA
S6021073	S6021173	2x7,5V	2x1333mA	2x1400mA
S6021075	S6021175	2x9V	2x1111mA	2x1200mA
S6021077	S6021177	2x12V	2x833mA	2x900mA
S6021079	S6021179	2x15V	2x667mA	2x700mA
S6021081	S6021181	2x18V	2x556mA	2x600mA
S6021089	S6021189	2x20V	2x500mA	2x550mA
S6021083	S6021183	2x24V	2x417mA	2x500mA

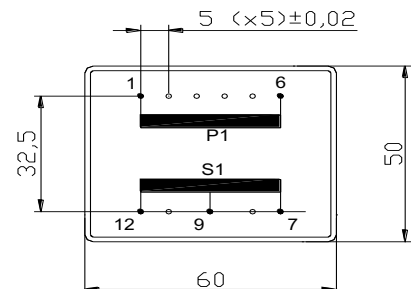

According EN61558, EN60590, EN60472, UL506, UL1585, UL5085