



# HIGH FREQUENCY TRANSFORMERS RM Series



[www.eifter.com](http://www.eifter.com)

[home>>index](#)

According EN61558, EN60590, EN60472, UL506, UL1585, UL5085 · External protection

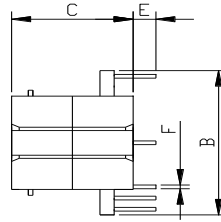
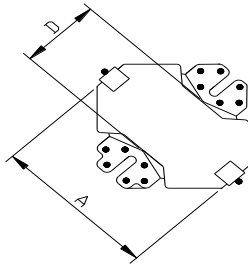

## MECHANICAL AND ELECTRICAL PARAMETERS

HORIZONTAL	A	B	C	D	E	F	MAX POWER
RM4	11.4	11.99	10.5	4.6	4.5	0,6	0.11W
RM5	14.6	15.1	10.5	6.8	4.5	0,6	0.17W
RM6	17.6	18,1	12.4	8.0	4.5	0,65	0.38W
RM8	22.5	23	16.4	10.8	4.5	0,65	0.91W
RM10	28.5	27.94	18.6	13.5	4.5	0,75	1.7W
RM12	36.75	37,25	23.5	16	4.5	0,75	3.0W
RM14	41.6	42.1	28.8	18.7	4.5	0,75	4.60W

- All measures are in mm.
- Customized Request

## FEATURES

- Operating Frequency: 50 to 200KHz
- Power range:0.1 to 4.6W
- Magnetic flux leakage small,high power density, suitable for flags desing.
- Operating temperature: -40°C to +105°C
- All parts meet ROHS compliance
- Construction according to regulation IEC EN60950, EN 61558
- Creepage distance according to regulation IEC EN60950, EN 61558, EN 60335
- Non standard transformers on request