



E4821 (EI 48/20,5)

12VA - Ta40°B

weight - 345gr.



www.efiter.com

home>>index

ENCAPSULATED TRANSFORMERS

According EN61558, EN60590, EN60472, UL506, UL1585, UL5085 · External protection

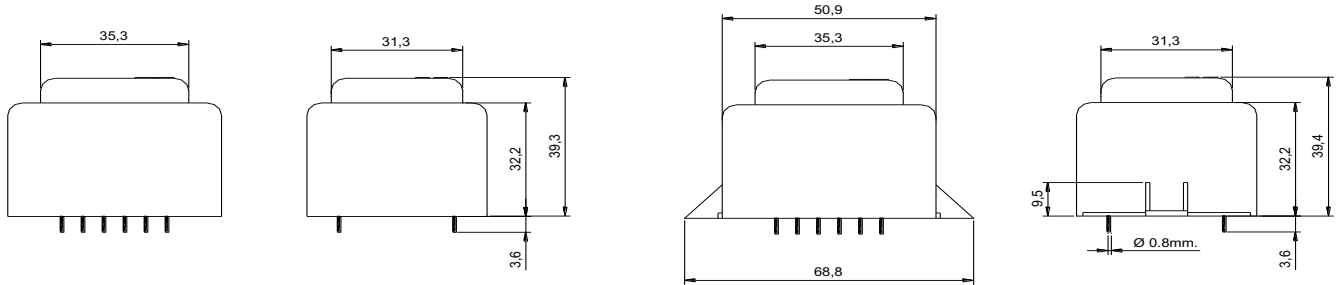

SINGLE SECONDARY, 12VA. Ta°40B

HR REFERENCE		HR REFERENCE with fixing holes		Vo/Vsec=1,25 Vo-->Is=0 Vsec --> Isec=In		Prot. Prim. 230V: 80mA/T 115V: 160mA/T
Prim. 230V	Prim. 115V	Prim. 230V	Prim. 115V	Vsec	Isec	Prot. Sec. mA/F
E4821014	E4821114	E4821514	E4821614	4,5V	2666mA	2500mA
E4821000	E4821100	E4821500	E4821600	6V	2000mA	2000mA
E4821002	E4821102	E4821502	E4821602	7,5V	1600mA	1600mA
E4821004	E4821104	E4821504	E4821604	9V	1333mA	1250mA
E4821006	E4821106	E4821506	E4821606	12V	1000mA	1000mA
E4821008	E4821108	E4821508	E4821608	15V	800mA	800mA
E4821010	E4821110	E4821510	E4821610	18V	666mA	630mA
E4821012	E4821112	E4821512	E4821612	24V	500mA	500mA

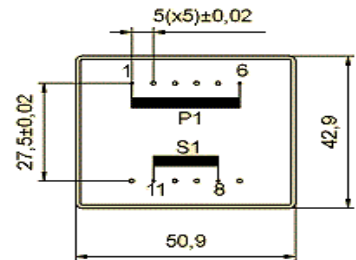

DUAL SECONDARY, 12VA. Ta°40B

HR REFERENCE		HR REFERENCE with fixing holes		Vo/Vsec=1,25 Vo-->Is=0 Vsec --> Isec=In		Prot. Prim. 230V: 80mA/T 115V: 160mA/T
Prim. 230V	Prim. 115V	Prim. 230V	Prim. 115V	Vsec	Isec	Prot. Sec. mA/F
E4821015	E4821115	E4821515	E4821615	2x4,5V	2x1333mA	2x1600mA
E4821001	E4821101	E4821501	E4821601	2x6V	2x1000mA	2x1250mA
E4821003	E4821103	E4821503	E4821603	2x7,5V	2x800mA	2x1000mA
E4821005	E4821105	E4821505	E4821605	2x9V	2x666mA	2x800mA
E4821007	E4821107	E4821507	E4821607	2x12V	2x500mA	2x630mA
E4821009	E4821109	E4821509	E4821609	2x15V	2x400mA	2x500mA
E4821011	E4821111	E4821511	E4821611	2x18V	2x333mA	2x400mA
E4821013	E4821113	E4821513	E4821613	2x24V	2x250mA	2x315mA

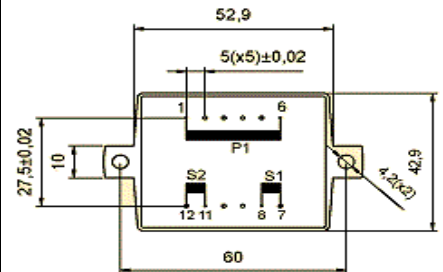

CENTER TAPPED, 12VA. Ta°40B

HR REFERENCE		HR REFERENCE with fixing holes		Vo/Vsec=1,25 Vo-->Is=0 Vsec --> Isec=In		Prot. Prim. 230V: 80mA/T 115V: 160mA/T
Prim. 230V	Prim. 115V	Prim. 230V	Prim. 115V	Vsec	Isec	Prot. Sec. mA/F
E4821035	E4821135	E4821535	E4821635	2x4,5V	2x1333mA	2x1600mA
E4821021	E4821121	E4821521	E4821621	2x6V	2x1000mA	2x1250mA
E4821023	E4821123	E4821523	E4821623	2x7,5V	2x800mA	2x1000mA
E4821025	E4821125	E4821525	E4821625	2x9V	2x666mA	2x800mA
E4821027	E4821127	E4821527	E4821627	2x12V	2x500mA	2x630mA
E4821029	E4821129	E4821529	E4821629	2x15V	2x400mA	2x500mA
E4821031	E4821131	E4821531	E4821631	2x18V	2x333mA	2x400mA
E4821033	E4821133	E4821533	E4821633	2x24V	2x250mA	2x315mA

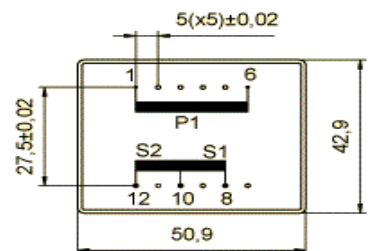

VDE certification: Vin 230V - Vout 4,5...36V or 2x4,5V...2x18V models aproved. File 40042543