



E3814 (EI 38/13,6)

4VA - Ta40°B

weight - 150gr.



www.efiter.com

[home>>index](#)

ENCAPSULATED TRANSFORMERS

According EN61558, EN60590, EN60472, UL506, UL1585, UL5085 · External protection

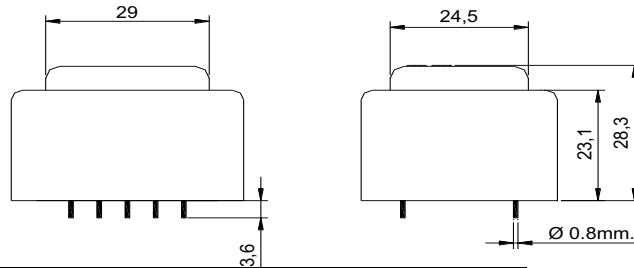

SINGLE SECONDARY, 4VA. Ta°40B

| HR REFERENCE | | Vo/Vsec=1,4 Vo → Is=0 Vsec → Isec=In | | Prot. Prim. 230V: 32mA/T 115V: 64mA/T |
|--------------|------------|---|-------|---|
| Prim. 230V | Prim. 115V | Vsec | Isec | Prot. Sec. mA/F |
| E3814014 | E3814114 | 4,5V | 888mA | 1000mA |
| E3814000 | E3814100 | 6V | 666mA | 800mA |
| E3814002 | E3814102 | 7,5V | 533mA | 630mA |
| E3814004 | E3814104 | 9V | 444mA | 500mA |
| E3814006 | E3814106 | 12V | 333mA | 400mA |
| E3814008 | E3814108 | 15V | 266mA | 315mA |
| E3814010 | E3814110 | 18V | 222mA | 250mA |
| E3814012 | E3814112 | 24V | 166mA | 200mA |

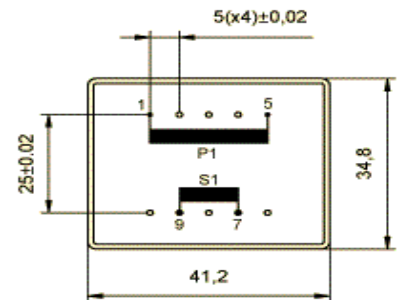

DUAL SECONDARY, 4VA. Ta°40B

| HR REFERENCE | | Vo/Vsec=1,4 Vo → Is=0 Vsec → Isec=In | | Prot. Prim. 230V:32mA/T 115V:64mA/T |
|--------------|------------|---|---------|---|
| Prim. 230V | Prim. 115V | Vsec | Isec | Prot. Sec. mA/F |
| E3814015 | E3814115 | 2x4,5V | 2x444mA | 2x500mA |
| E3814001 | E3814101 | 2x6V | 2x333mA | 2x400mA |
| E3814003 | E3814103 | 2x7,5V | 2x266mA | 2x315mA |
| E3814005 | E3814105 | 2x9V | 2x222mA | 2x250mA |
| E3814007 | E3814107 | 2x12V | 2x166mA | 2x200mA |
| E3814009 | E3814109 | 2x15V | 2x133mA | 2x160mA |
| E3814011 | E3814111 | 2x18V | 2x111mA | 2x125mA |
| E3814013 | E3814113 | 2x24V | 2x83mA | 2x100mA |

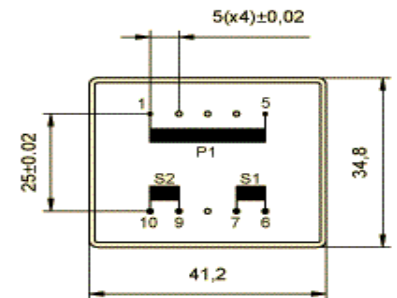

CENTER TAPPED, 4VA. Ta°40B

| HR REFERENCE | | Vo/Vsec=1,4 Vo → Is=0 Vsec → Isec=In | | Prot. Prim. 230V:32mA/T 115V:64mA/T |
|--------------|------------|---|---------|---|
| Prim. 230V | Prim. 115V | Vsec | Isec | Prot. Sec. mA/F |
| E3814035 | E3814135 | 2x4,5V | 2x444mA | 2x500mA |
| E3814021 | E3814121 | 2x6V | 2x333mA | 2x400mA |
| E3814023 | E3814123 | 2x7,5V | 2x266mA | 2x315mA |
| E3814025 | E3814125 | 2x9V | 2x222mA | 2x250mA |
| E3814027 | E3814127 | 2x12V | 2x166mA | 2x200mA |
| E3814029 | E3814129 | 2x15V | 2x133mA | 2x160mA |
| E3814031 | E3814131 | 2x18V | 2x111mA | 2x125mA |
| E3814033 | E3814133 | 2x24V | 2x83mA | 2x100mA |

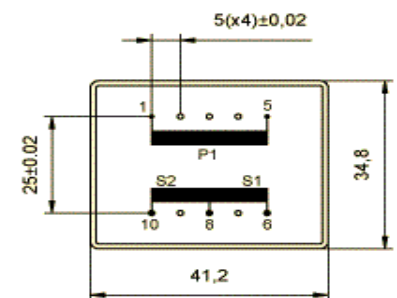

According EN61558, EN60590, EN60472, UL506, UL1585, UL5085 .