



# E3023 (EI 30/23)

2,8VA - Ta70°B

weight - 140gr.



[www.efiter.com](http://www.efiter.com)

[home>>index](#)

## ENCAPSULATED TRANSFORMERS

According EN61558, EN60590, EN60472, UL506, UL1585, UL5085 · Short circuit proof

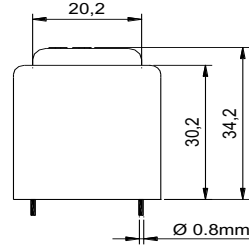
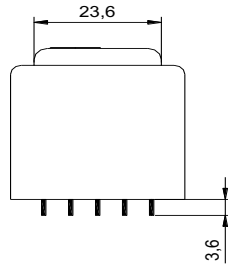

### SINGLE SECONDARY, 2,8VA. Ta70B

HR REFERENCE		Vo/Vsec=1,7 Vo → Is=0 Vsec → Isec=In		Protection
Prim. 230V	Prim. 115V	Vsec	Isec	
E3023064	E3023164	4,5V	622mA	Short circuit proof
E3023050	E3023150	6V	466mA	
E3023052	E3023152	7,5V	373mA	
E3023054	E3023154	9V	311mA	
E3023056	E3023156	12V	233mA	
E3023058	E3023158	15V	186mA	
E3023060	E3023160	18V	155mA	
E3023062	E3023162	24V	116mA	

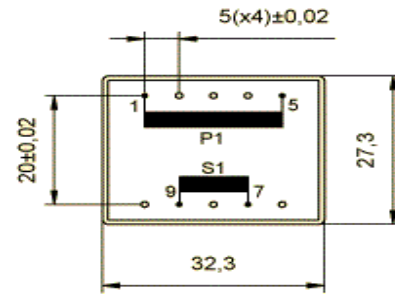

### DUAL SECONDARY, 2,8VA. Ta70B

HR REFERENCE		Vo/Vsec=1,7 Vo → Is=0 Vsec → Isec=In		Protection
Prim. 230V	Prim. 115V	Vsec	Isec	
E3023065	E3023165	2x4,5V	2x311mA	Short circuit proof
E3023051	E3023151	2x6V	2x233mA	
E3023053	E3023153	2x7,5V	2x186mA	
E3023055	E3023155	2x9V	2x155mA	
E3023057	E3023157	2x12V	2x116mA	
E3023059	E3023159	2x15V	2x93mA	
E3023061	E3023161	2x18V	2x77mA	
E3023063	E3023163	2x24V	2x58mA	

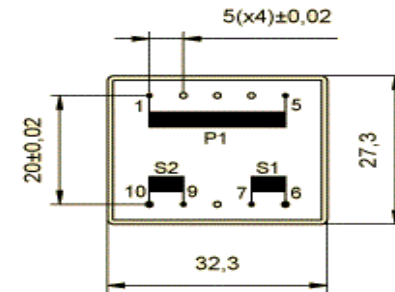

### CENTER TAPPED, 2,8VA. Ta70B

HR REFERENCE		Vo/Vsec=1,7 Vo → Is=0 Vsec → Isec=In		Protection
Prim. 230V	Prim. 115V	Vsec	Isec	
E3023085	E3023185	2x4,5V	2x311mA	Short circuit proof
E3023071	E3023171	2x6V	2x233mA	
E3023073	E3023173	2x7,5V	2x186mA	
E3023075	E3023175	2x9V	2x155mA	
E3023077	E3023177	2x12V	2x116mA	
E3023079	E3023179	2x15V	2x93mA	
E3023081	E3023181	2x18V	2x77mA	
E3023083	E3023183	2x24V	2x58mA	

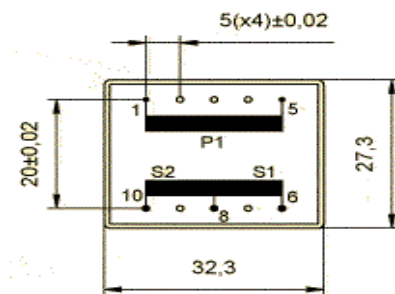

According EN61558, EN60590, EN60472, UL506, UL1585, UL5085 .