



E3016 GREEN SERIES

EI 30/16.5 2,4VA - Ta40°B

weight - 100gr.



www.efiter.com

home>>index

ENCAPSULATED TRANSFORMERS

According EN61558, EN60590, EN60472, UL506, UL1585, UL5085 · Short circuit proof

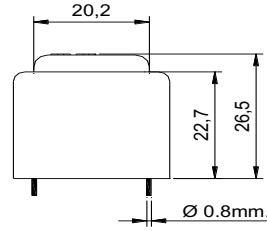
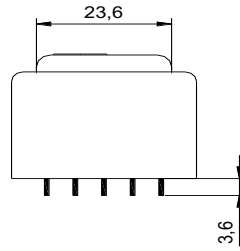

SINGLE SECONDARY, 2,4VA. Ta°40B

HR REFERENCE		Vo/Vsec=1,7 Vo → Is=0 Vsec → Isec=In		Protection
Prim. 230V	Prim. 115V	Vsec	Isec	
E3016814	E3016914	4,5V	533mA	Short circuit proof
E3016800	E3016900	6V	400mA	
E3016802	E3016902	7,5V	320mA	
E3016804	E3016904	9V	266mA	
E3016806	E3016906	12V	200mA	
E3016808	E3016908	15V	160mA	
E3016810	E3016910	18V	133mA	
E3016812	E3016912	24V	100mA	

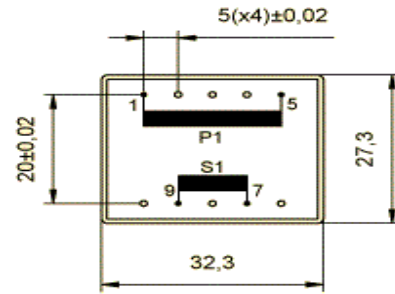

DUAL SECONDARY, 2,4VA. Ta°40B

HR REFERENCE		Vo/Vsec=1,7 Vo → Is=0 Vsec → Isec=In		Protection
Prim. 230V	Prim. 115V	Vsec	Isec	
E3016815	E3016915	2x4,5V	2x266mA	Short circuit proof
E3016801	E3016901	2x6V	2x200mA	
E3016803	E3016903	2x7,5V	2x160mA	
E3016805	E3016905	2x9V	2x133mA	
E3016807	E3016907	2x12V	2x100mA	
E3016809	E3016909	2x15V	2x80mA	
E3016811	E3016911	2x18V	2x66mA	
E3016813	E3016913	2x24V	2x50mA	

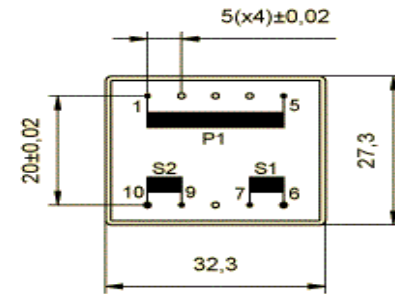

CENTER TAPPED, 2,4VA. Ta°40B

HR REFERENCE		Vo/Vsec=1,7 Vo → Is=0 Vsec → Isec=In		Protection
Prim. 230V	Prim. 115V	Vsec	Isec	
E3016035	E3016935	2x4,5V	2x266mA	Short circuit proof
E3016021	E3016921	2x6V	2x200mA	
E3016023	E3016923	2x7,5V	2x160mA	
E3016025	E3016925	2x9V	2x133mA	
E3016027	E3016927	2x12V	2x100mA	
E3016029	E3016929	2x15V	2x80mA	
E3016031	E3016931	2x18V	2x66mA	
E3016033	E3016933	2x24V	2x50mA	

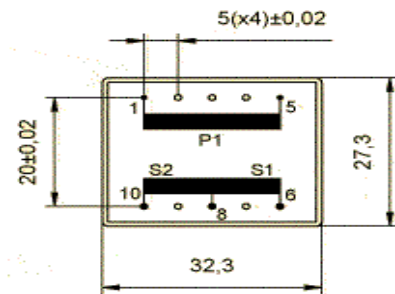

ENEC + VDE certification: Vin 230V - Vout 4,5...30V or 2x4,5V...2x15V models approved. File 400445905