



# E3013 (EI 30/12,5)

1,8VA - Ta40°B

weight - 85gr.

[www.efiter.com](http://www.efiter.com)

[home>>index](#)



## ENCAPSULATED TRANSFORMERS

According EN61558, EN60590, EN60472, UL506, UL1585, UL5085 · Short circuit proof

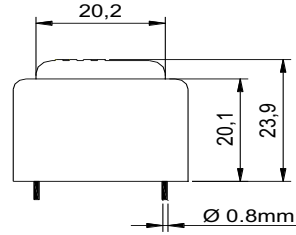
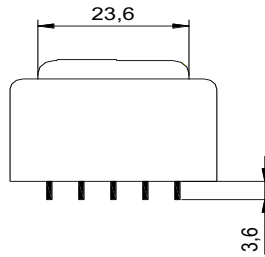

### SINGLE SECONDARY, 1,8VA. Ta°40B

HR REFERENCE		Vo/Vsec=1,7 Vo --> Is=0 Vsec --> Isec=In		Protection
Prim. 230V	Prim. 115V	Vsec	Isec	
E3013014	E3013114	4,5V	400mA	Short circuit proof
E3013000	E3013100	6V	300mA	
E3013002	E3013102	7,5V	240mA	
E3013004	E3013104*	9V	200mA	
E3013006	E3013106	12V	150mA	
E3013008	E3013108	15V	120mA	
E3013010	E3013110	18V	100mA	
E3013012	E3013112	24V	75mA	

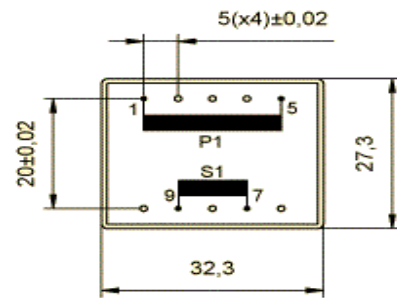

### DUAL SECONDARY, 1,8VA. Ta°40B

HR REFERENCE		Vo/Vsec=1,7 Vo --> Is=0 Vsec --> Isec=In		Protection
Prim. 230V	Prim. 115V	Vsec	Isec	
E3013015	E3013115	2x4,5V	2x200mA	Short circuit proof
E3013001	E3013101	2x6V	2x150mA	
E3013003	E3013103	2x7,5V	2x120mA	
E3013005	E3013105	2x9V	2x100mA	
E3013007	E3013107	2x12V	2x75mA	
E3013009	E3013109	2x15V	2x60mA	
E3013011	E3013111	2x18V	2x50mA	
E3013013	E3013113	2x24V	2x37mA	

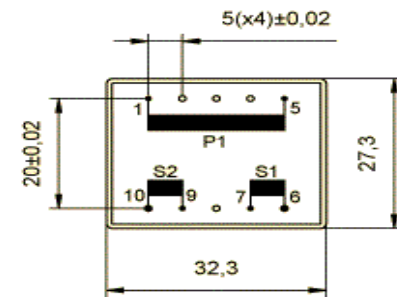

### CENTER TAPPED, 1,8VA. Ta°40B

HR REFERENCE		Vo/Vsec=1,7 Vo --> Is=0 Vsec --> Isec=In		Protection
Prim. 230V	Prim. 115V	Vsec	Isec	
E3013035	E3013135	2x4,5V	2x200mA	Short circuit proof
E3013021	E3013121	2x6V	2x150mA	
E3013023	E3013123	2x7,5V	2x120mA	
E3013025	E3013125	2x9V	2x100mA	
E3013027	E3013127	2x12V	2x75mA	
E3013029	E3013129	2x15V	2x60mA	
E3013031	E3013131	2x18V	2x50mA	
E3013033	E3013133	2x24V	2x37mA	

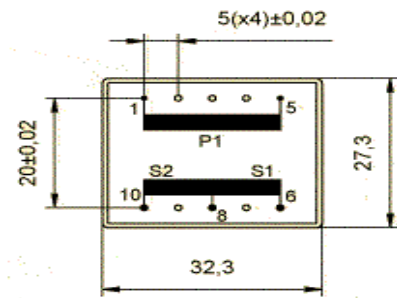

ENEC + VDE certification: Vin 230V - Vout 4,5...30V or 2x4,5V...2x15V models approved. File 40044506