



E3011 (EI 30/10,5)

1,5VA - Ta70°B

weight - 75gr.



www.efiter.com

[home>>index](#)

ENCAPSULATED TRANSFORMERS

According EN61558, EN60590, EN60472, UL506, UL1585, UL5085 · Short circuit proof

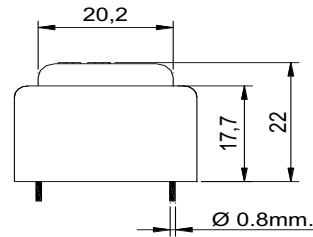
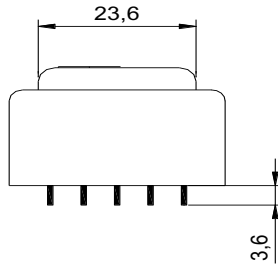

SINGLE SECONDARY, 1,5VA. Ta70B

| HR REFERENCE | | Vo/Vsec=1,7 Vo → Is=0 Vsec → Isec=In | | Protection |
|--------------|------------|---|-------|---------------------|
| Prim. 230V | Prim. 115V | Vsec | Isec | |
| E3011464 | E3011564 | 4,5V | 333mA | Short circuit proof |
| E3011450 | E3011550 | 6V | 250mA | |
| E3011452 | E3011552 | 7,5V | 200mA | |
| E3011454 | E3011554 | 9V | 160mA | |
| E3011456 | E3011556 | 12V | 125mA | |
| E3011458 | E3011558 | 15V | 100mA | |
| E3011460 | E3011560 | 18V | 83mA | |
| E3011462 | E3011562 | 24V | 62mA | |

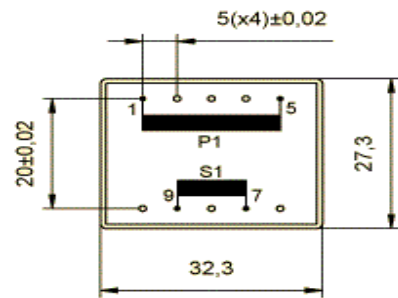

DUAL SECONDARY, 1,5VA. Ta70B

| HR REFERENCE | | Vo/Vsec=1,7 Vo → Is=0 Vsec → Isec=In | | Protection |
|--------------|------------|---|---------|---------------------|
| Prim. 230V | Prim. 115V | Vsec | Isec | |
| E3011465 | E3011565 | 2x4,5V | 2x166mA | Short circuit proof |
| E3011451 | E3011551 | 2x6V | 2x125mA | |
| E3011453 | E3011553 | 2x7,5V | 2x100mA | |
| E3011455 | E3011555 | 2x9V | 2x86mA | |
| E3011457 | E3011557 | 2x12V | 2x75mA | |
| E3011459 | E3011559 | 2x15V | 2x50mA | |
| E3011461* | E3011561 | 2x18V | 2x41mA | |
| E3011463* | E3011563 | 2x24V | 2x31mA | |

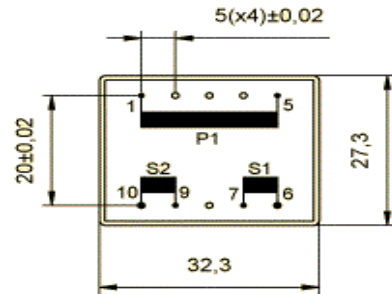

CENTER TAPPED, 1,5VA. Ta70B

| HR REFERENCE | | Vo/Vsec=1,7 Vo → Is=0 Vsec → Isec=In | | Protection |
|--------------|------------|---|---------|---------------------|
| Prim. 230V | Prim. 115V | Vsec | Isec | |
| E3011485 | E3011585 | 2x4,5V | 2x166mA | Short circuit proof |
| E3011471 | E3011571 | 2x6V | 2x125mA | |
| E3011473 | E3011573 | 2x7,5V | 2x100mA | |
| E3011475 | E3011575 | 2x9V | 2x86mA | |
| E3011477 | E3011577 | 2x12V | 2x75mA | |
| E3011479 | E3011579 | 2x15V | 2x50mA | |
| E3011481* | E3011581 | 2x18V | 2x41mA | |
| E3011483* | E3011583 | 2x24V | 2x31mA | |

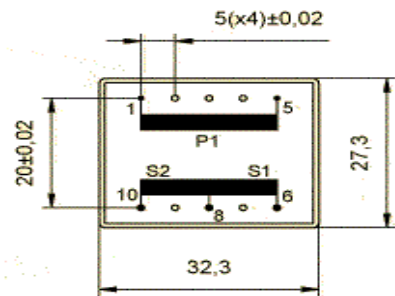

ENEC + VDE certification: Vin 230V - Vout 4,5...30V or 2x4,5V...2x15V models approved. File 40044906