



C8450 (EI 84)

130VA - Ta70°B

Dim:70x84x97mm



www.efiter.com

[home>>index](#)

OPEN FRAME TRANSFORMERS

According EN61558, EN60590, EN60472, UL506, UL1585, UL5085 · External protection

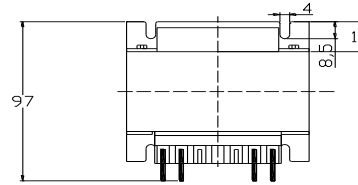
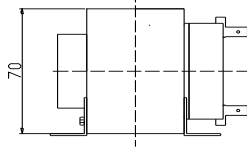
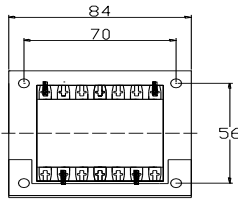

SINGLE SECONDARY, 130VA. Ta70°B

HR REFERENCE		Vo/Vsec=1,3 Vo → Is=0 Vsec → Isec=In		Prot. Prim. 230V: 50mA/T 115V: 100mA/T
Prim. 230V	Prim. 115V	Vsec	Isec	Prot. Sec. mA/F
C8450064	C8450164	4,5V	28889mA	29000mA
C8450050	C8450150	6V	21667mA	22000mA
C8450052	C8450152	7,5V	17333mA	18000mA
C8450054	C8450154	9V	14444mA	15000mA
C8450056	C8450156	12V	10833mA	11000mA
C8450058	C8450158	15V	8667mA	9000mA
C8450060	C8450160	18V	7222mA	8000mA
C8450070	C8450170	20V	6500mA	7000mA
C8450062	C8450172	24V	5417mA	6000mA

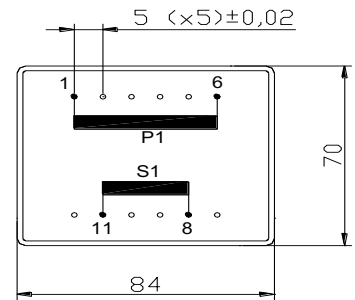

DUAL SECONDARY, 130VA. Ta70°B

HR REFERENCE		Vo/Vsec=1,3 Vo → Is=0 Vsec → Isec=In		Prot. Prim. 230V: 50mA/T 115V: 100mA/T
Prim. 230V	Prim. 115V	Vsec	Isec	Prot. Sec. mA/F
C8450065	C8450165	2x4,5V	2x14444mA	2x15000mA
C8450051	C8450151	2x6V	2x10833mA	2x11000mA
C8450053	C8450153	2x7,5V	2x8667mA	2x10000mA
C8450055	C8450155	2x9V	2x7222mA	2x8000mA
C8450057	C8450157	2x12V	2x5417mA	2x6000mA
C8450059	C8450159	2x15V	2x4333mA	2x5000mA
C8450061	C8450161	2x18V	2x3611mA	2x4000mA
C8450069	C8450169	2x20V	2x3250mA	2x4000mA
C8450063	C8450163	2x24V	2x2708mA	2x3000mA

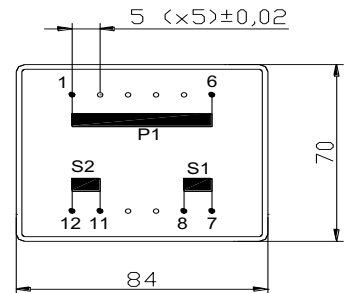

CENTER TAPPED, 130VA. Ta70°B

HR REFERENCE		Vo/Vsec=1,3 Vo → Is=0 Vsec → Isec=In		Prot. Prim. 230V: 50mA/T 115V: 100mA/T
Prim. 230V	Prim. 115V	Vsec	Isec	Prot. Sec. mA/F
C8450085	C8450185	2x4,5V	2x14444mA	2x15000mA
C8450071	C8450171	2x6V	2x10833mA	2x11000mA
C8450073	C8450173	2x7,5V	2x8667mA	2x10000mA
C8450075	C8450175	2x9V	2x7222mA	2x8000mA
C8450077	C8450177	2x12V	2x5417mA	2x6000mA
C8450079	C8450179	2x15V	2x4333mA	2x5000mA
C8450081	C8450181	2x18V	2x3611mA	2x4000mA
C8450089	C8450189	2x20V	2x3250mA	2x4000mA
C8450083	C8450183	2x24V	2x2708mA	2x3000mA

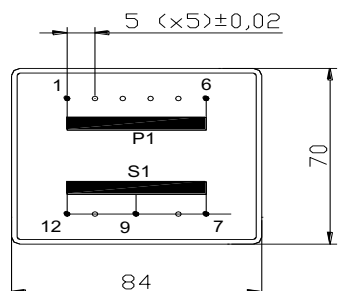

According EN61558, EN60590, EN60472, UL506, UL1585, UL5085