

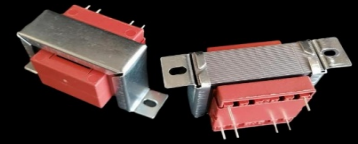

C8444 (EI 84)

100VA - Ta70°B

Dim:70x84x91mm



www.efiter.com

[home>>index](#)

OPEN FRAME TRANSFORMERS

According EN61558, EN60590, EN60472, UL506, UL1585, UL5085 · External protection

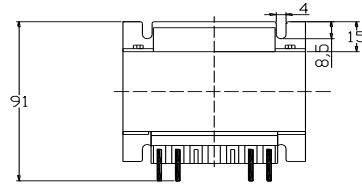
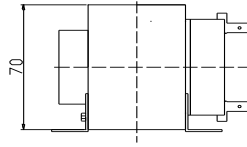
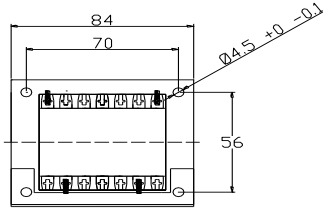

SINGLE SECONDARY, 100VA. Ta70B

HR REFERENCE		Vo/Vsec=1,3 Vo → Is=0 Vsec → Isec=In		Prot. Prim. 230V: 50mA/T 115V: 100mA/T
Prim. 230V	Prim. 115V	Vsec	Isec	Prot. Sec. mA/F
C8444064	C8444164	4,5V	22222mA	23000mA
C8444050	C8444150	6V	16667mA	17000mA
C8444052	C8444152	7,5V	13333mA	15000mA
C8444054	C8444154	9V	11111mA	12000mA
C8444056	C8444156	12V	8333mA	10000mA
C8444058	C8444158	15V	6667mA	7000mA
C8444060	C8444160	18V	5556mA	200mA
C8444070	C8444170	20V	5000mA	200mA
C8444062	C8444172	24V	4167mA	160mA

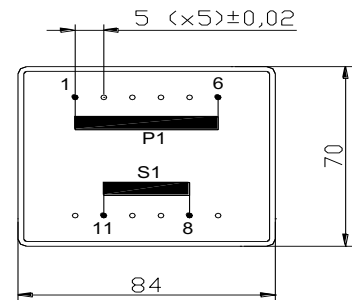

DUAL SECONDARY, 100VA. Ta70B

HR REFERENCE		Vo/Vsec=1,3 Vo → Is=0 Vsec → Isec=In		Prot. Prim. 230V: 50mA/T 115V: 100mA/T
Prim. 230V	Prim. 115V	Vsec	Isec	Prot. Sec. mA/F
C8444065	C8444165	2x4,5V	2x11111mA	2x12000mA
C8444051	C8444151	2x6V	2x8333mA	2x9000mA
C8444053	C8444153	2x7,5V	2x6667mA	2x7000mA
C8444055	C8444155	2x9V	2x5556mA	2x6000mA
C8444057	C8444157	2x12V	2x4167mA	2x5000mA
C8444059	C8444159	2x15V	2x3333mA	2x4000mA
C8444061	C8444161	2x18V	2x2778mA	2x3000mA
C8444069	C8444169	2x20V	2x2500mA	2x3000mA
C8444063	C8444163	2x24V	2x2083mA	2x2100mA

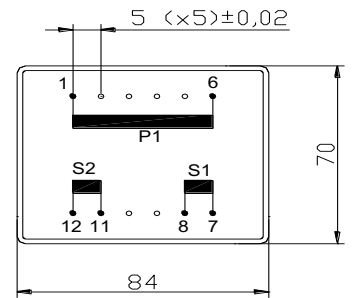

CENTER TAPPED, 100VA. Ta70B

HR REFERENCE		Vo/Vsec=1,3 Vo → Is=0 Vsec → Isec=In		Prot. Prim. 230V: 50mA/T 115V: 100mA/T
Prim. 230V	Prim. 115V	Vsec	Isec	Prot. Sec. mA/F
C8444085	C8444185	2x4,5V	2x11111mA	2x12000mA
C8444071	C8444171	2x6V	2x8333mA	2x9000mA
C8444073	C8444173	2x7,5V	2x6667mA	2x7000mA
C8444075	C8444175	2x9V	2x5556mA	2x6000mA
C8444077	C8444177	2x12V	2x4167mA	2x5000mA
C8444079	C8444179	2x15V	2x3333mA	2x4000mA
C8444081	C8444181	2x18V	2x2778mA	2x3000mA
C8444089	C8444189	2x20V	2x2500mA	2x3000mA
C8444083	C8444183	2x24V	2x2083mA	2x2100mA

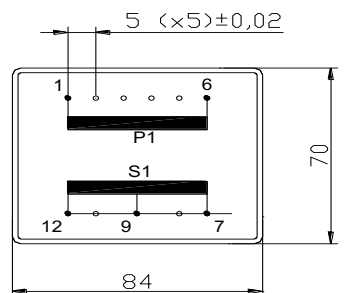

According EN61558, EN60590, EN60472, UL506, UL1585, UL5085