



C7525 (EI 75)

70VA - Ta40°C

Dim:62x75x69mm



www.efiter.com

[home>>index](#)

OPEN FRAME TRANSFORMERS

According EN61558, EN60590, EN60472, UL506, UL1585, UL5085 · External protection

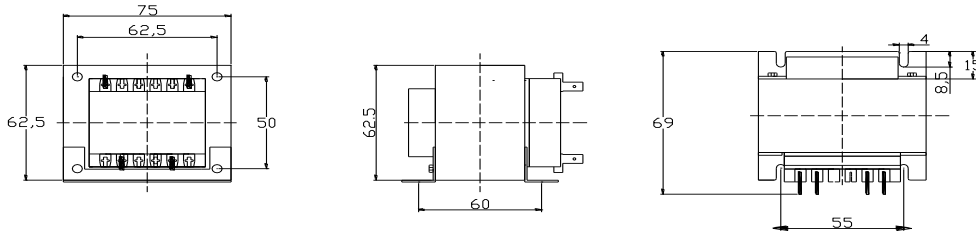

SINGLE SECONDARY, 70VA. Ta=40°C

HR REFERENCE		Vo/Vsec=1,3 Vo → Is=0 Vsec → Isec=In		Prot. Prim. 230V: 50mA/T 115V: 100mA/T
Prim. 230V	Prim. 115V	Vsec	Isec	Prot. Sec. mA/F
C7525014	C7525114	4,5V	15556mA	16000mA
C7525000	C7525100	6V	11667mA	12000mA
C7525002	C7525102	7,5V	93333mA	10000mA
C7525004	C7525104	9V	7778mA	8000mA
C7525006	C7525106	12V	5833mA	6000mA
C7525008	C7525108	15V	4667mA	5000mA
C7525010	C7525110	18V	3889mA	4000mA
C7525020	C7525120	20V	3500mA	3750mA
C7525012	C7525112	24V	2917mA	3000mA

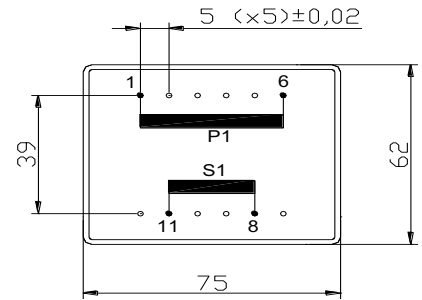

DUAL SECONDARY, 70VA. Ta=40°C

HR REFERENCE		Vo/Vsec=1,3 Vo → Is=0 Vsec → Isec=In		Prot. Prim. 230V: 50mA/T 115V: 100mA/T
Prim. 230V	Prim. 115V	Vsec	Isec	Prot. Sec. mA/F
C7525015	C7525115	2x4,5V	2x7778mA	2x8000mA
C7525001	C7525101	2x6V	2x5833mA	2x6000mA
C7525003	C7525103	2x7,5V	2x4667mA	2x5000mA
C7525005	C7525105	2x9V	2x3889mA	2x4000mA
C7525007	C7525107	2x12V	2x2917mA	2x3000mA
C7525009	C7525109	2x15V	2x2333mA	2x2500mA
C7525011	C7525111	2x18V	2x1944mA	2x2250mA
C7525019	C7525119	2x20V	2x1750mA	2x2000mA
C7525013	C7525113	2x24V	2x1458mA	2x1500mA

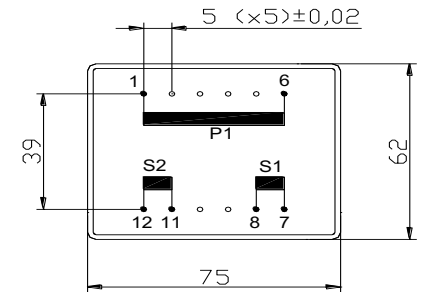

CENTER TAPPED, 70VA. Ta=40°C

HR REFERENCE		Vo/Vsec=1,3 Vo → Is=0 Vsec → Isec=In		Prot. Prim. 230V: 50mA/T 115V: 100mA/T
Prim. 230V	Prim. 115V	Vsec	Isec	Prot. Sec. mA/F
C7525035	C7525135	2x4,5V	2x7778mA	2x8000mA
C7525021	C7525121	2x6V	2x5833mA	2x6000mA
C7525023	C7525123	2x7,5V	2x4667mA	2x5000mA
C7525025	C7525125	2x9V	2x3889mA	2x4000mA
C7525027	C7525127	2x12V	2x2917mA	2x3000mA
C7525029	C7525129	2x15V	2x2333mA	2x2500mA
C7525031	C7525131	2x18V	2x1944mA	2x2250mA
C7525039	C7525139	2x20V	2x1750mA	2x2000mA
C7525033	C7525133	2x24V	2x1458mA	2x1500mA

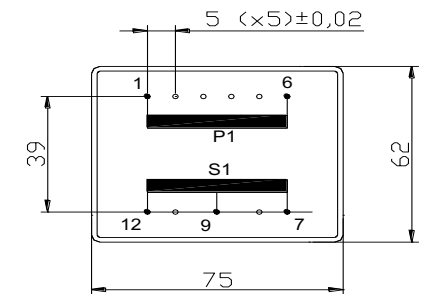

According EN61558, EN60590, EN60472, UL506, UL1585, UL5085